

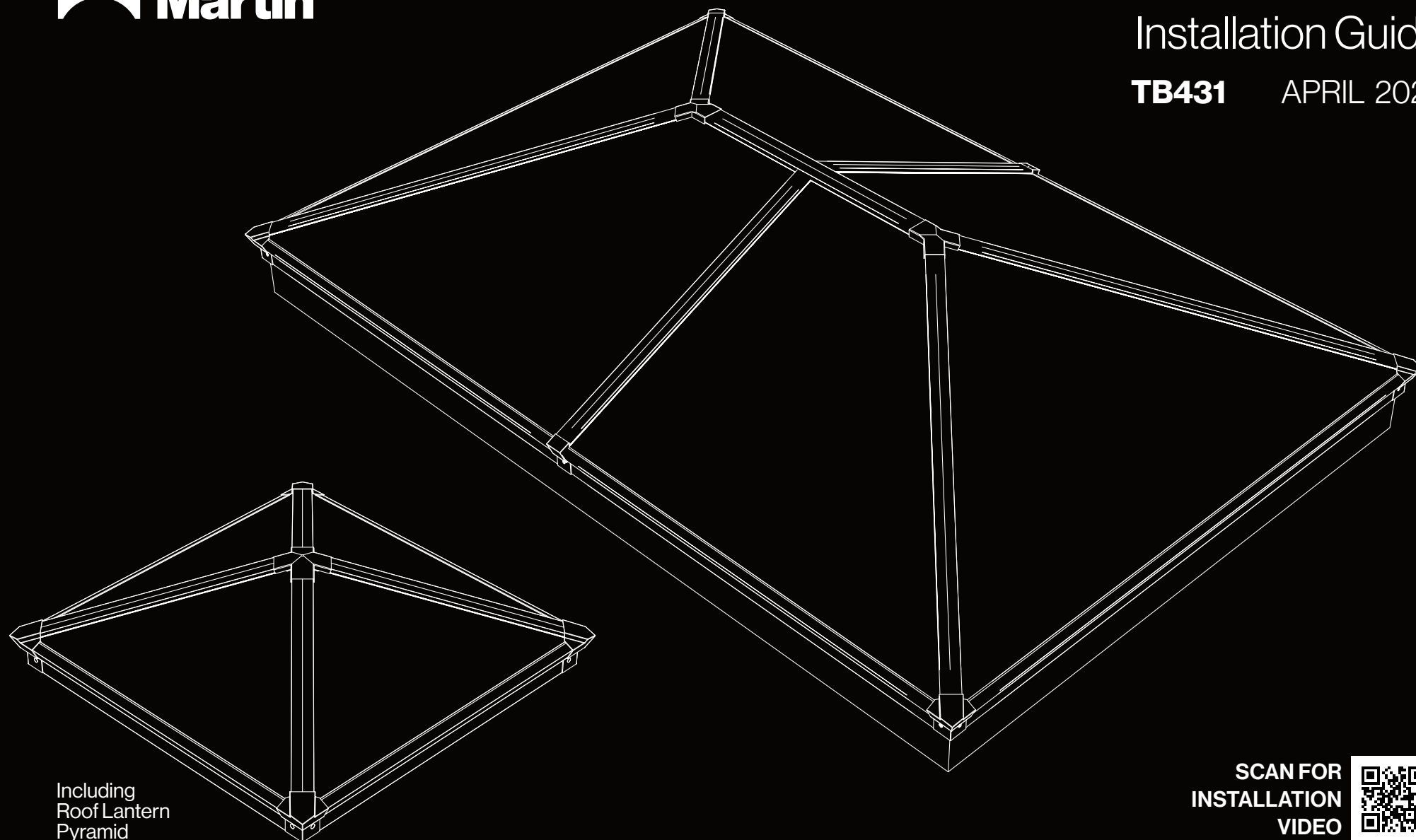

Roof Lantern

Installation Guide

TB431 APRIL 2025



Including
Roof Lantern
Pyramid

SCAN FOR
INSTALLATION
VIDEO



Uprand Requirements

Construct finished, insulated and weathered builder's upstand to dimensions shown.

Roof covering must cover **side and top** of insulated upstand in accordance with manufacturer's installation recommendations. There should be no excessive build-up of layers, and the top surface should be level and free from protrusions or projections which may prevent adequate weatherproofing.

Roof Lantern rooflights are intended for installation onto a fully weathered and insulated builder's upstand on flat and low pitch roofs. The surface of flat roofs normally require some degree of pitch to ensure adequate water runoff. For aesthetic reasons we recommend that the upstand is built with 0° pitch i.e. not parallel with the pitched roof surface. The rooflight can accommodate being installed on an upstand with a pitch of up to 5° but please note that this will likely result in a 'lopsided' appearance.

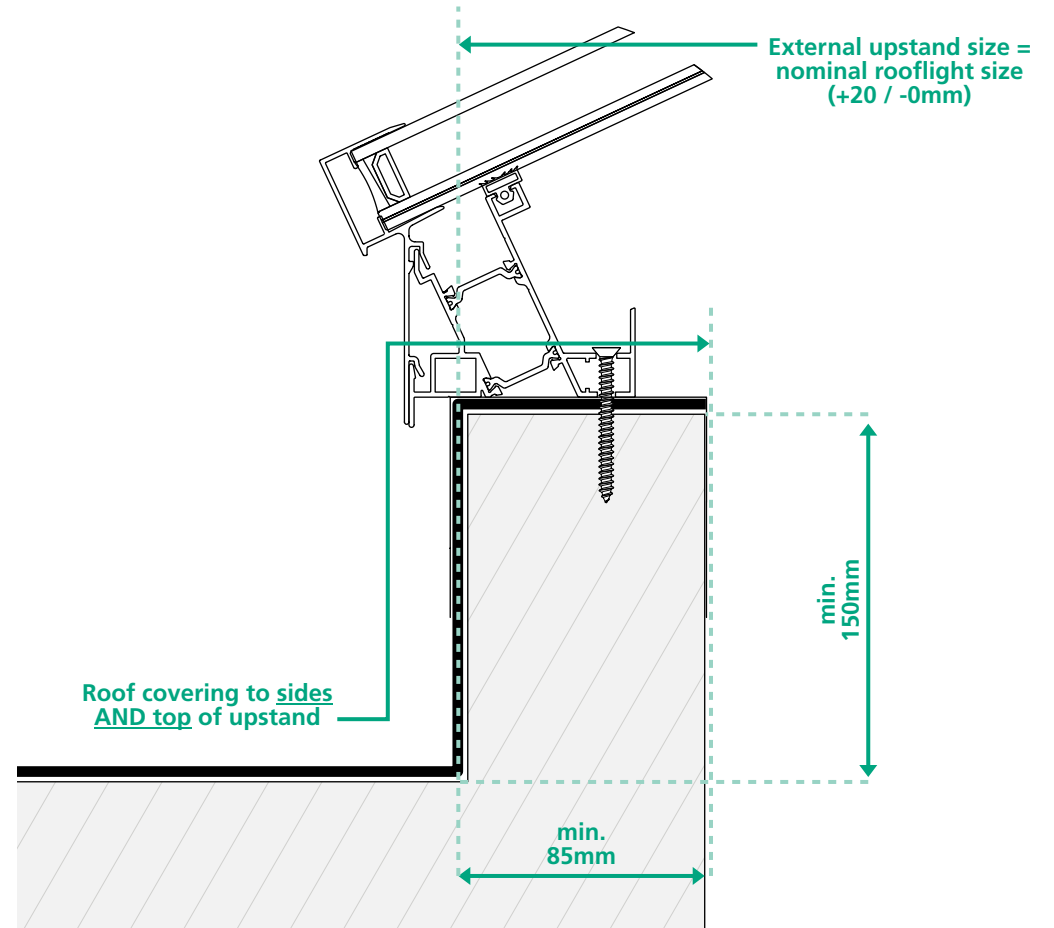
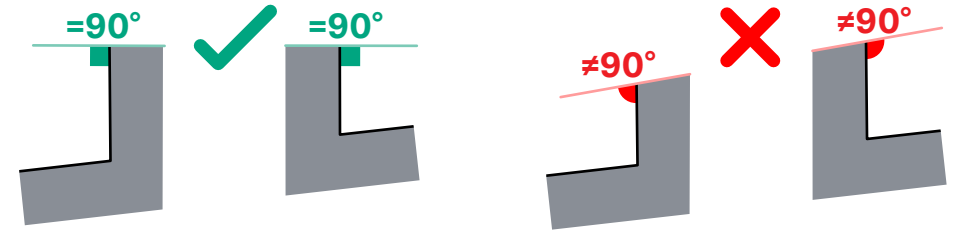
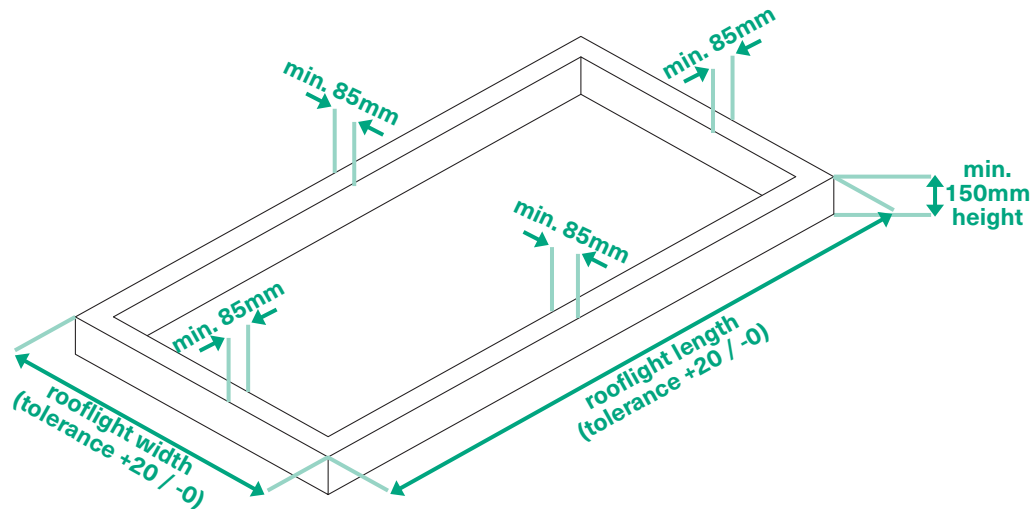

Health & Safety



Warning: this product is designed for installation by professional roofing installers, who are responsible for establishing a safe method of work. All risks involved, including those involved in roof access and working around (and if necessary across) an open roof aperture must be assessed, and suitable precautions taken to minimise those risks, with a safe method of work established and documented for each project.

Instructions must be followed **carefully** and in the correct order otherwise warranty may be invalidated.



IMPACT DRIVERS MUST NOT BE USED

Technical Support

For any technical information/queries please contact your supplier. The manufacturer operates a policy of continuous product improvement, and reserves the right to alter specifications at any time without notice. Every effort has been taken to ensure all details contained in this document are correct at the time of going to press but this document should be used only as a guide and does not in any way form part of a contract or warranty. It is the customer's responsibility to ensure that the product is suitable for the actual conditions of use, which are beyond the control of the manufacturer.

Safety Equipment Required



Safety Gloves
Cut level 5 or E gloves

Required as per following standards
EN 288; EN ISO 21420

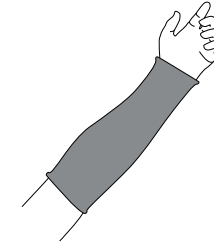

**Cut Resistant
Sleeves**

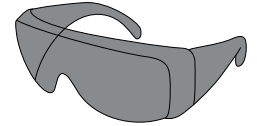

Safety Glasses

Tools Required



**Electric
Screwdriver**
NO IMPACT DRIVERS

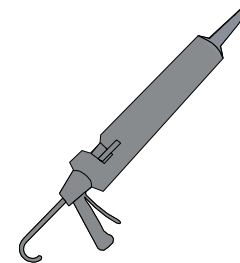

Sealant

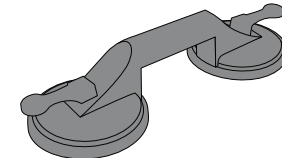

Glass Sucker(s)
Recommended for
larger sizes

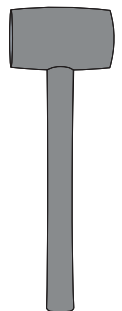

Rubber Mallet

Contents

4 pane lantern

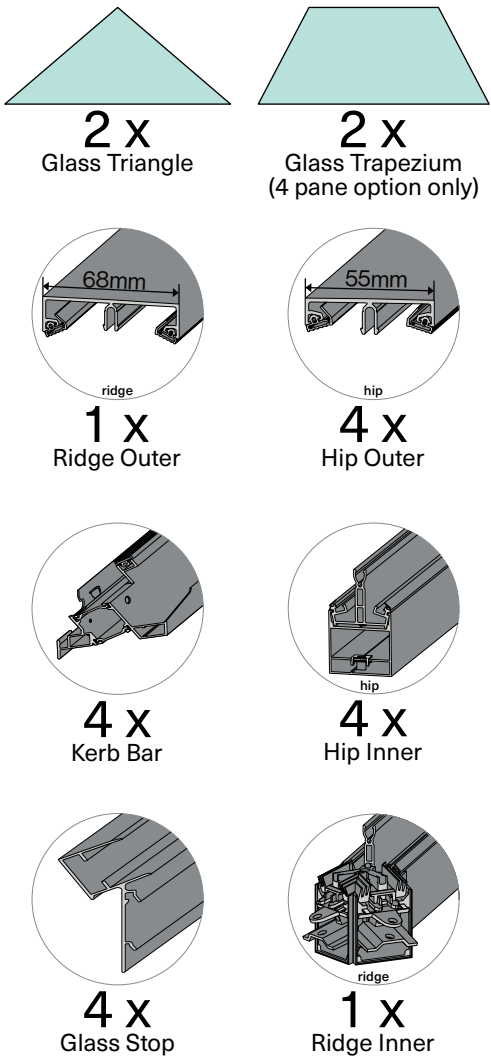

Components Box (only use fixings supplied)

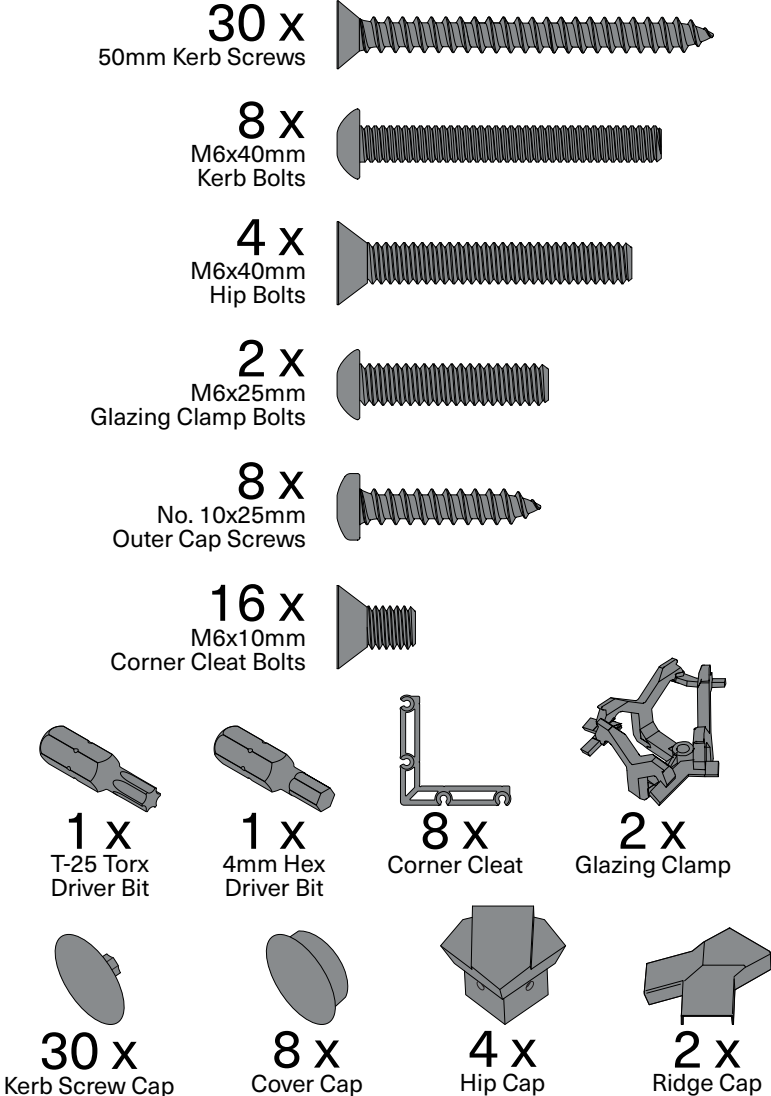

6 pane lantern

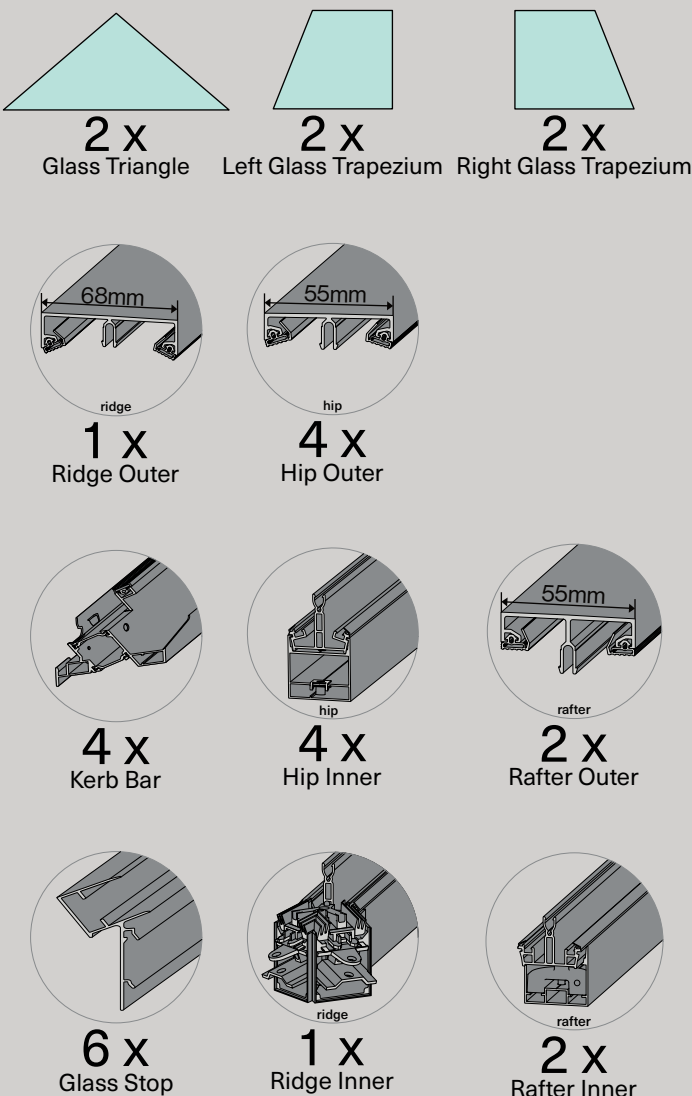

Components Box (only use fixings supplied)

30 x
50mm Kerb Screws

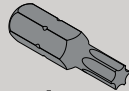
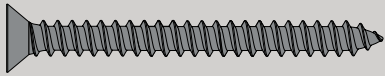

10 x
M6x40mm
Kerb Bolts

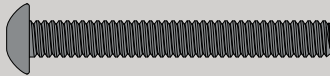

1 x
T-25 Torx
Driver Bit

4 x
M6x40mm
Hip Bolts

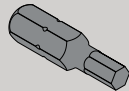
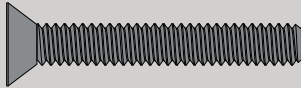

2 x
M6x35mm
Rafter Bolts
(black bolt)

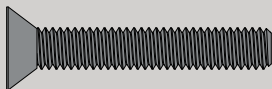

1 x
4mm Hex
Driver Bit

2 x
M6x25mm
Glazing Clamp Bolts

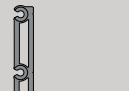
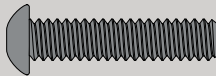

8 x
Corner Cleat

10 x
No. 10x25mm
Outer Cap Screws

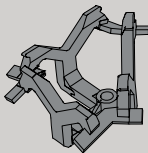
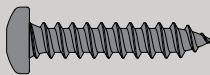

2 x
Glazing Clamp

16 x
M6x10mm
Corner Cleat Bolts

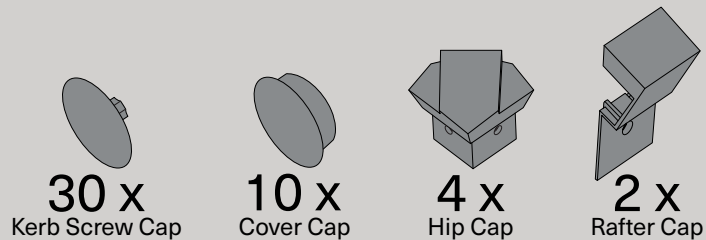

30 x
Kerb Screw Cap

10 x
Cover Cap

4 x
Hip Cap

2 x
Rafter Cap

2 x
Ridge Cap

Pyramid

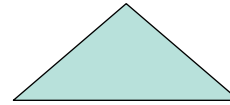

4 x
Glass Triangle

4 x
Kerb Bar

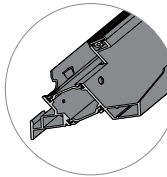

4 x
Hip Outer

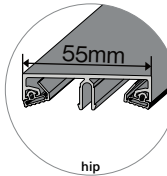

4 x
Hip Inner

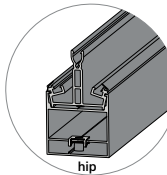

4 x
Glass Stop

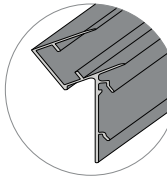

Components Box (only use fixings supplied)

30 x
50mm Kerb Screws

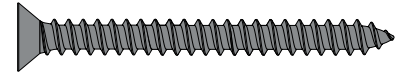

8 x
M6x40mm
Kerb Bolts

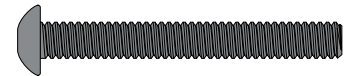

4 x
M6x40mm
Hip Bolts



1 x
M6x25mm
Glazing Clamp Bolt



8 x
No. 10x25mm
Outer Cap Screws

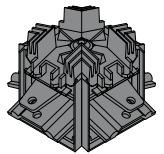
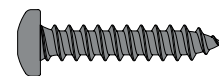

1 x
Inner Casting

16 x
M6x10mm
Corner Cleat Bolts



1 x
T-25 Torx
Driver Bit

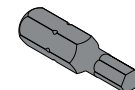

1 x
4mm Hex
Driver Bit

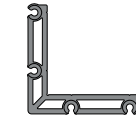

8 x
Corner Cleat

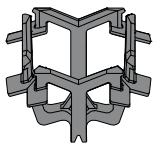

1 x
Glazing Clamp

30 x
Kerb Screw Cap



8 x
Cover Cap

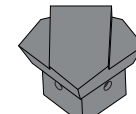

4 x
Hip Cap



1 x
Ridge Cap

1. Assemble base frame



16 x
M6x10mm
Corner Cleat Bolts

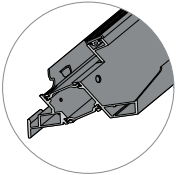

4 x
Kerb Bar

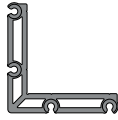

8 x
Corner Cleat

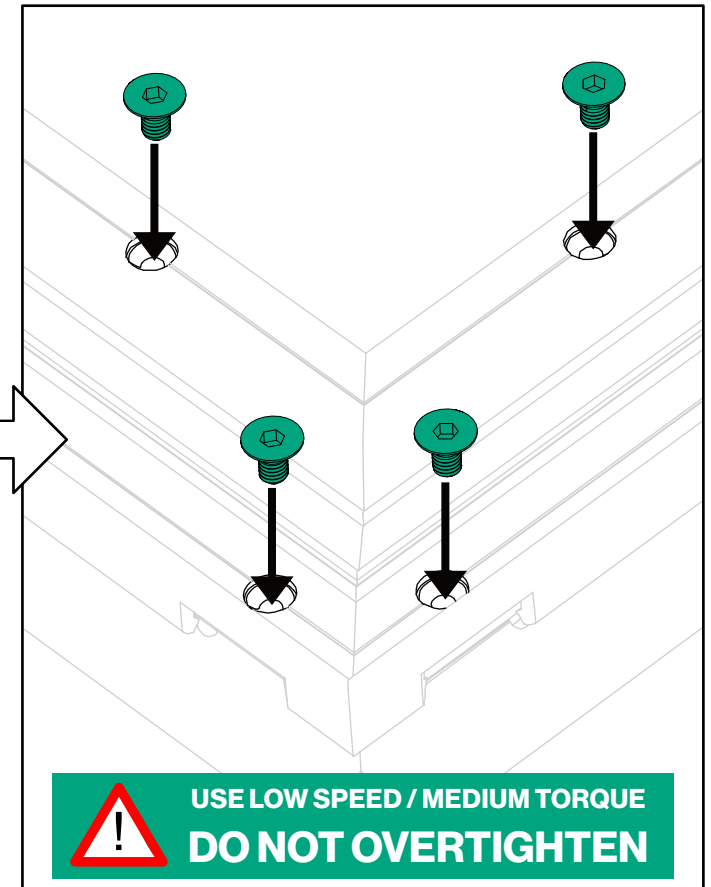
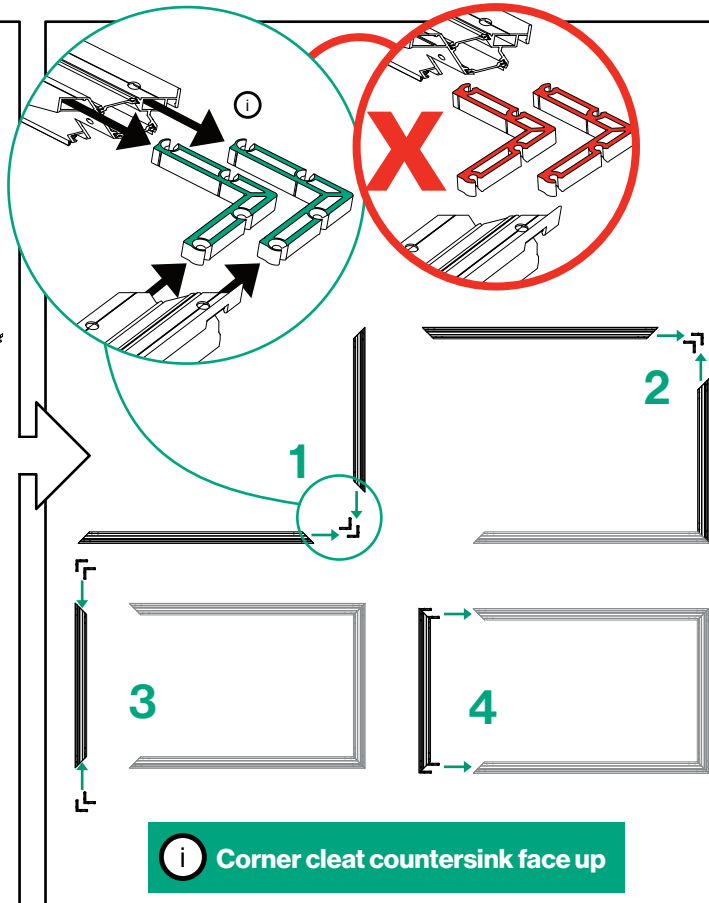
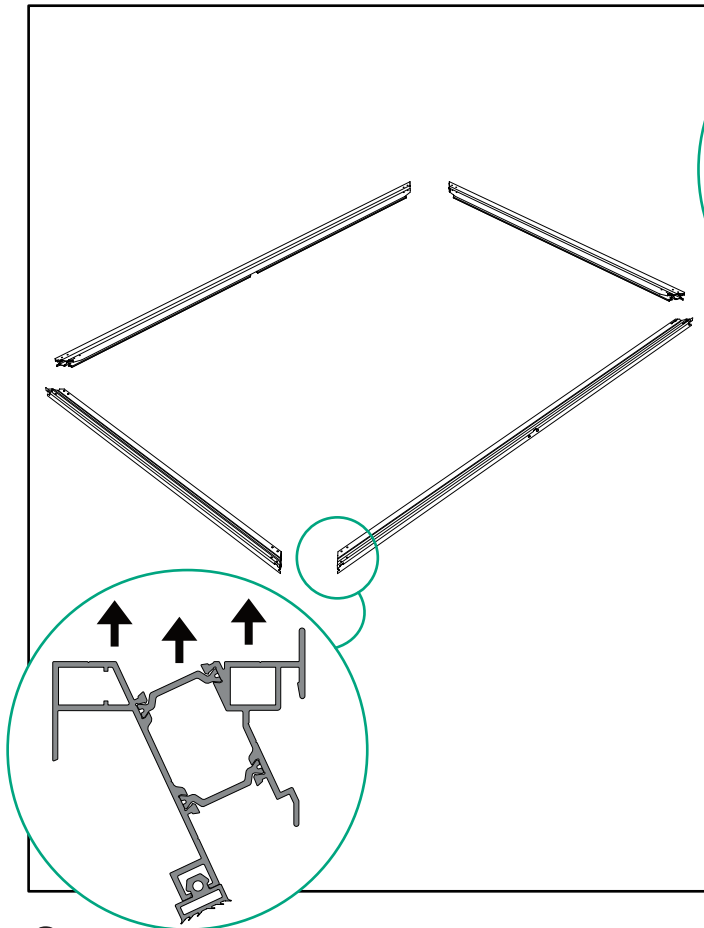

2. Apply sealant then rotate and position frame on upstand

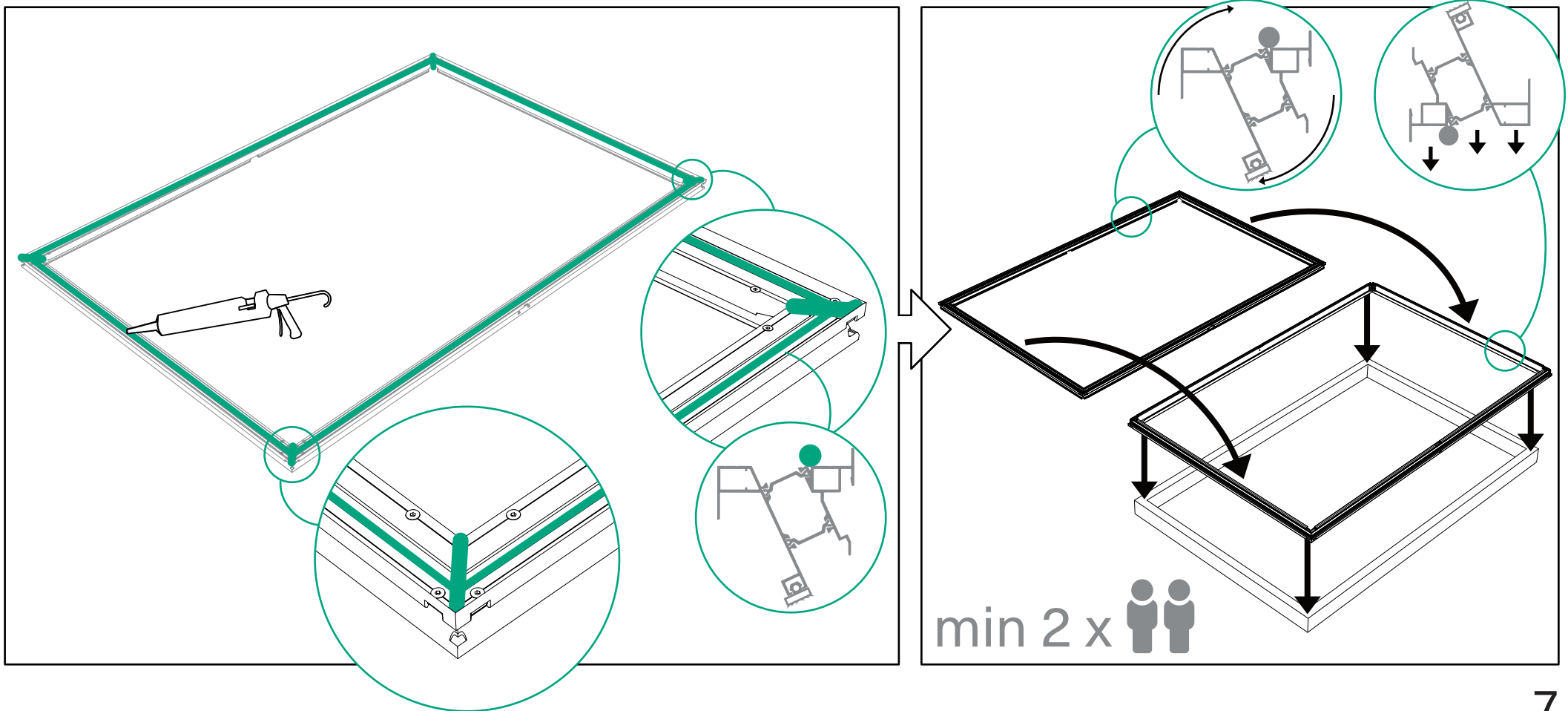

3. Connect spider frame

4 & 6 pane lantern only

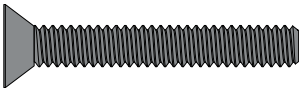

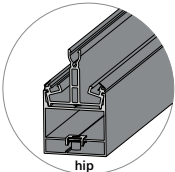
4 x
M6x40mm
Hip Bolts

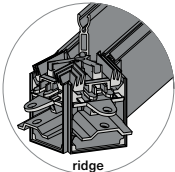

4 x
Hip Inner

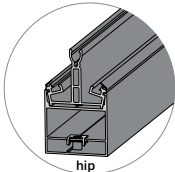

1 x
Ridge Inner

Pyramid only

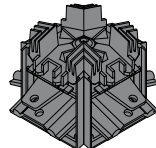

4 x
M6x40mm
Hip Bolts

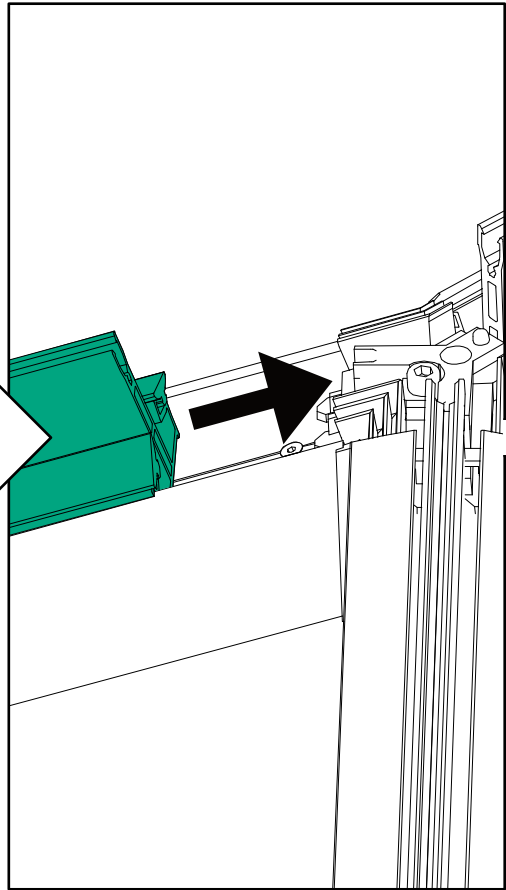
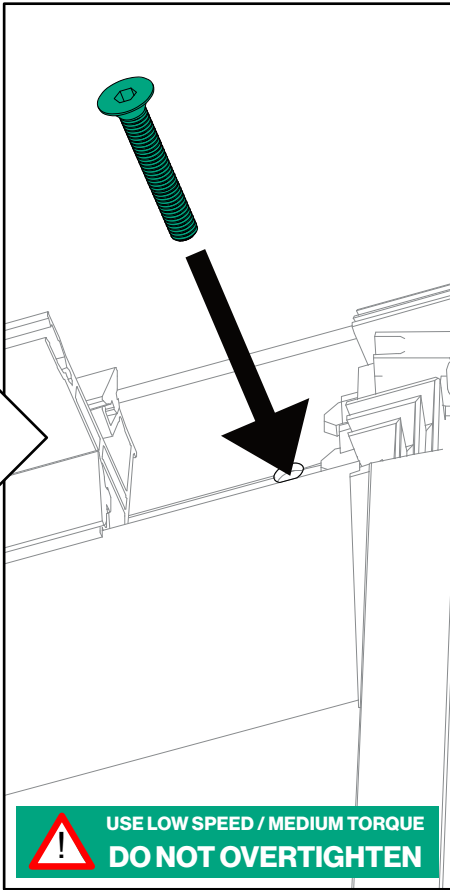
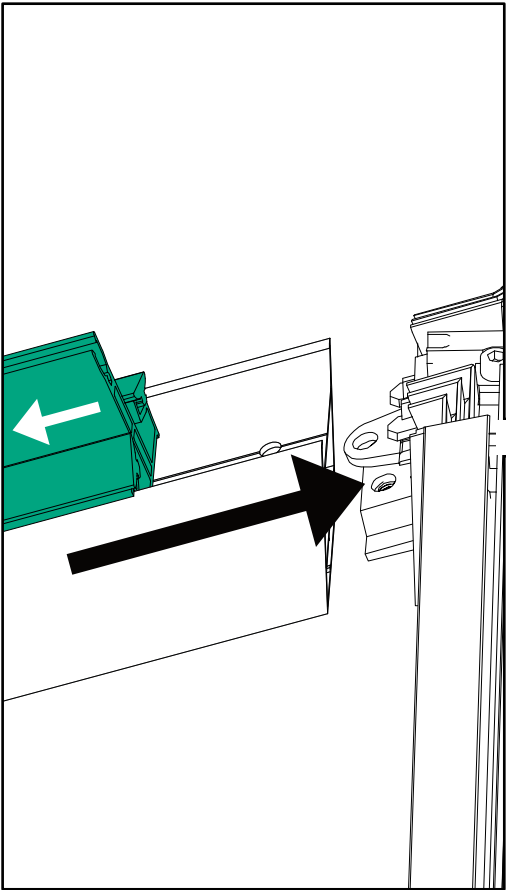
4 x
Hip Inner

1 x
Inner Casting

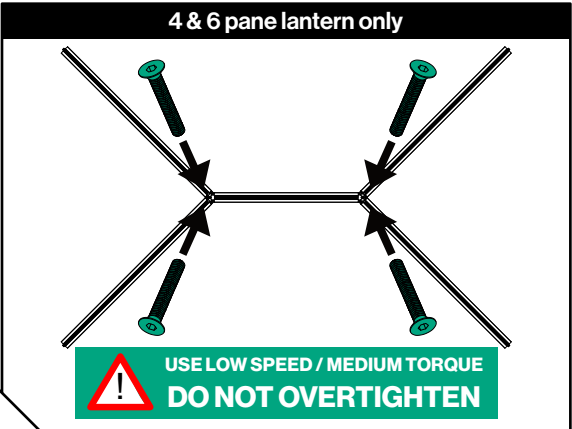

4 & 6 pane lantern only



USE LOW SPEED / MEDIUM TORQUE
DO NOT OVERTIGHTEN

Pyramid only

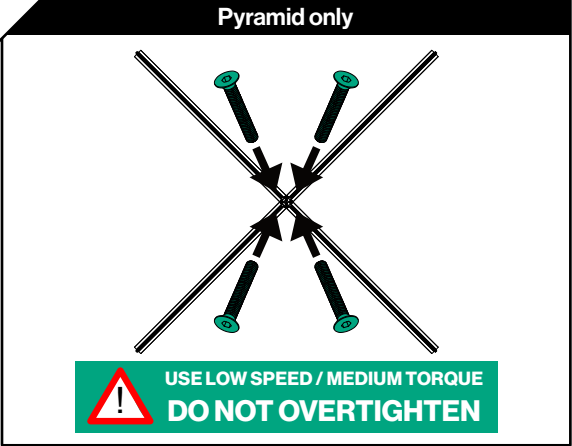

USE LOW SPEED / MEDIUM TORQUE
DO NOT OVERTIGHTEN

6 pane lantern only

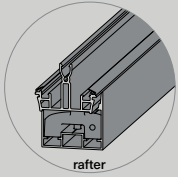

2 x
Rafter Inner

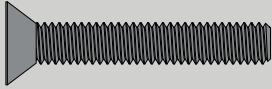

2 x
M6x35mm
Rafter Bolts
(black bolt)

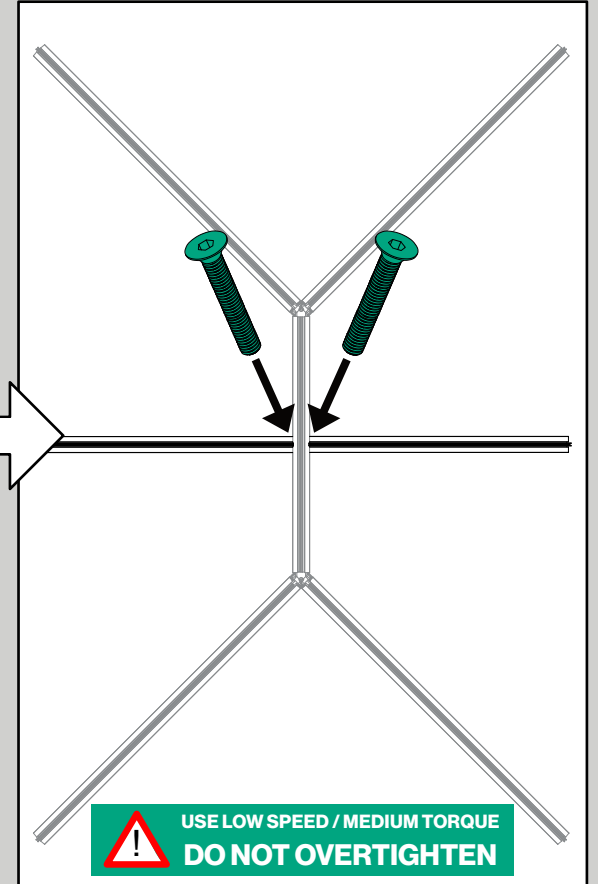
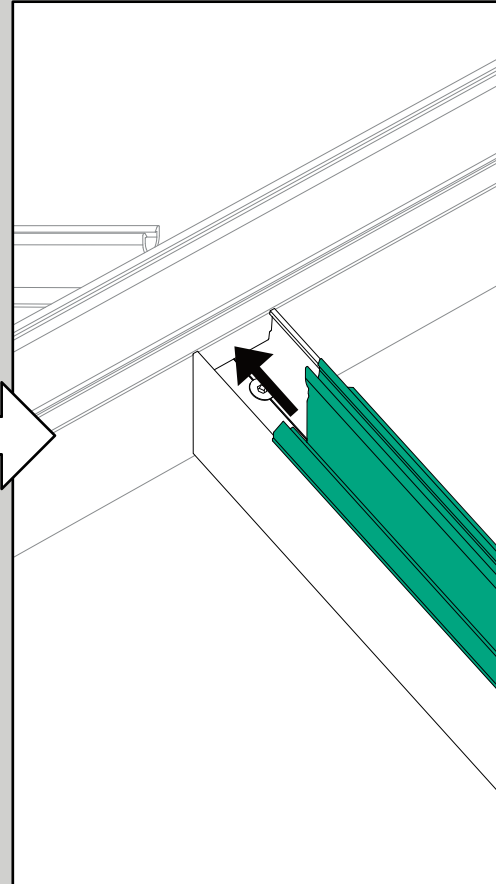
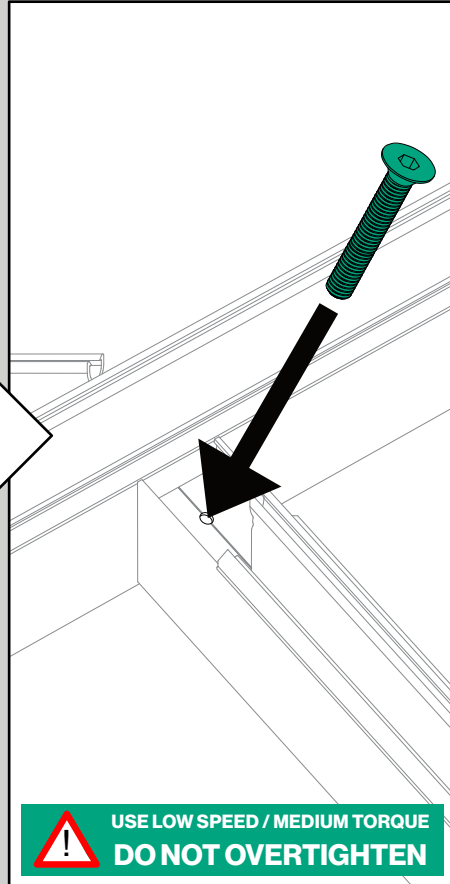
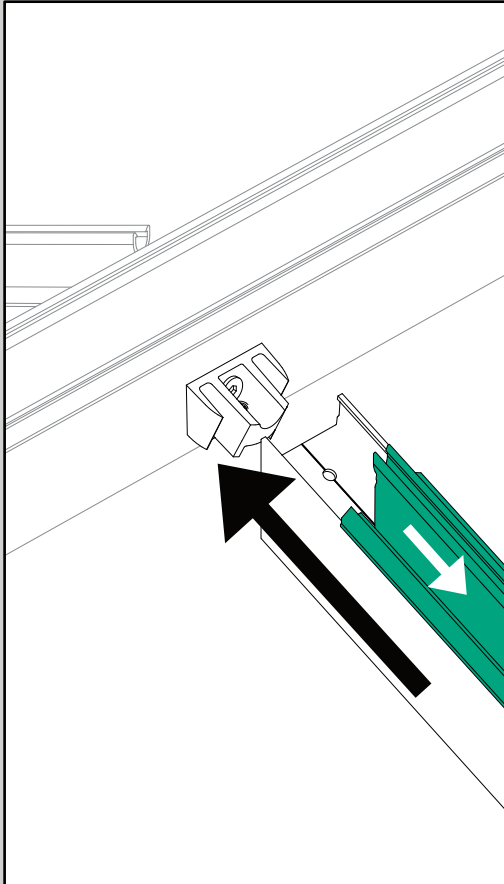

4. Fit spider frame to base frame

4 pane lantern & pyramid only

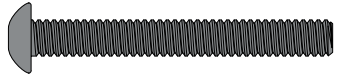

8 x
M6x40mm
Kerb Bolts

6 pane lantern only

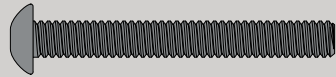

10 x
M6x40mm
Kerb Bolts

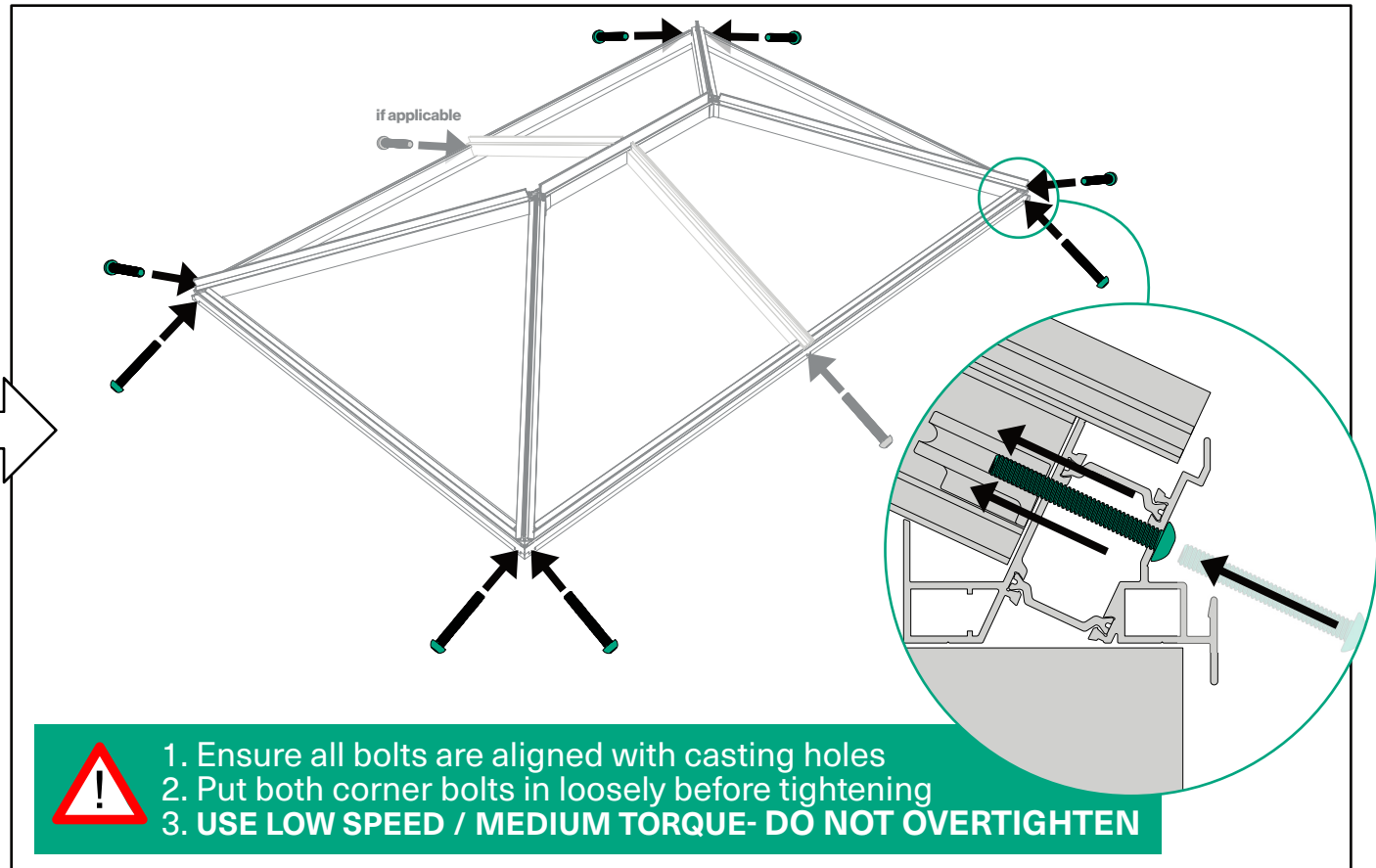
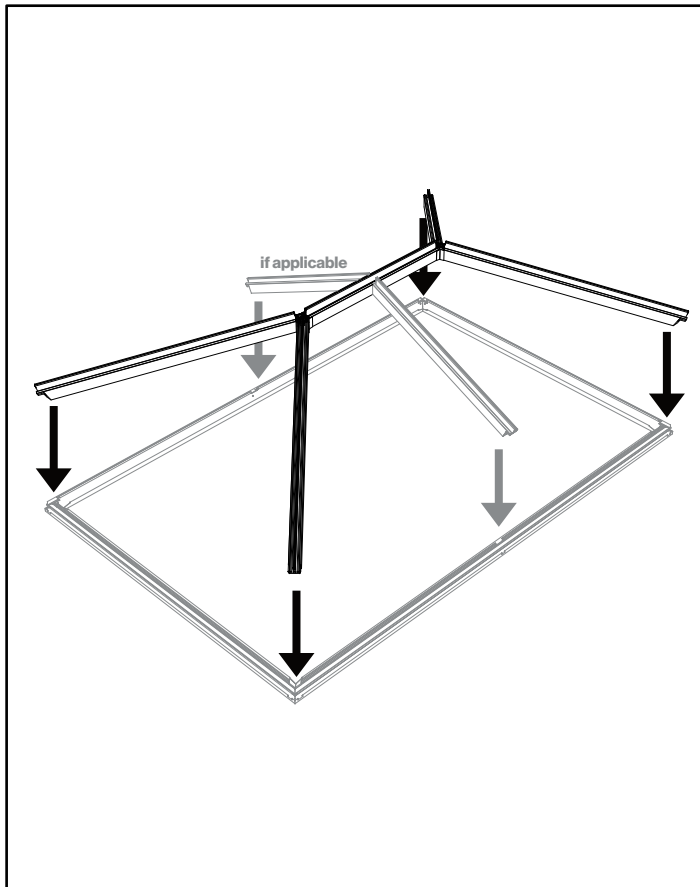

5. Fix unit to upstand through pre-drilled holes

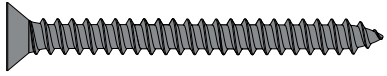

30 x
50mm Kerb Screws

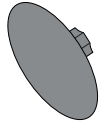

30 x
Kerb Screw Caps

N.B. Roof Lantern is supplied with the maximum fixings required. Smaller sizes will have surplus screws.

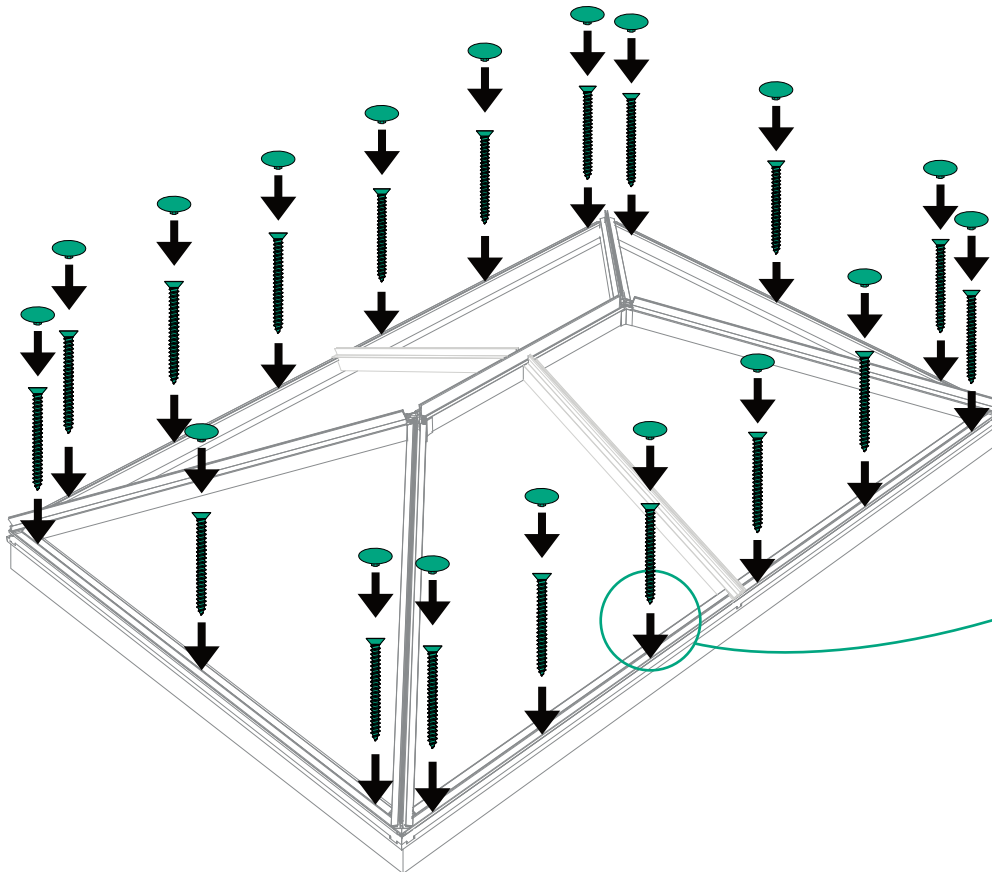

USE HIGH SPEED / MEDIUM TORQUE
DO NOT OVERTIGHTEN

6. Prepare glass

4 pane lantern only

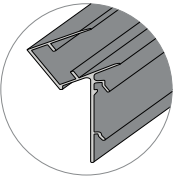

4 x
Glass Stop



2 x
Glass Trapezium

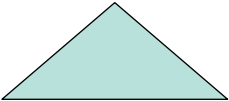

2 x
Glass Triangle

6 pane lantern only

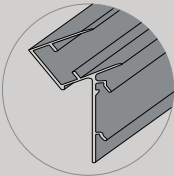

6 x
Glass Stop

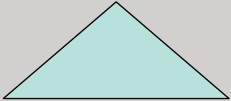

2 x
Glass Triangle



2 x
Left Glass Trapezium



2 x
Right Glass Trapezium

Pyramid only

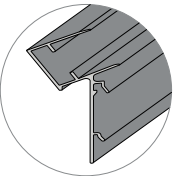

4 x
Glass Stop

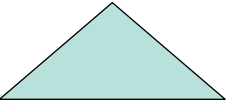

4 x
Glass Triangle

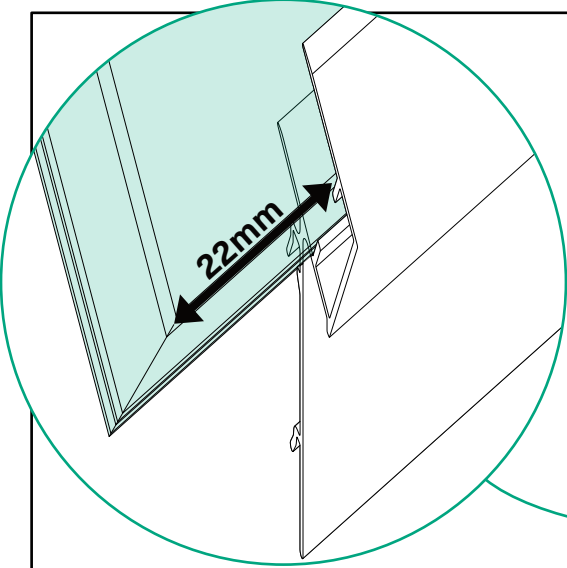

22mm

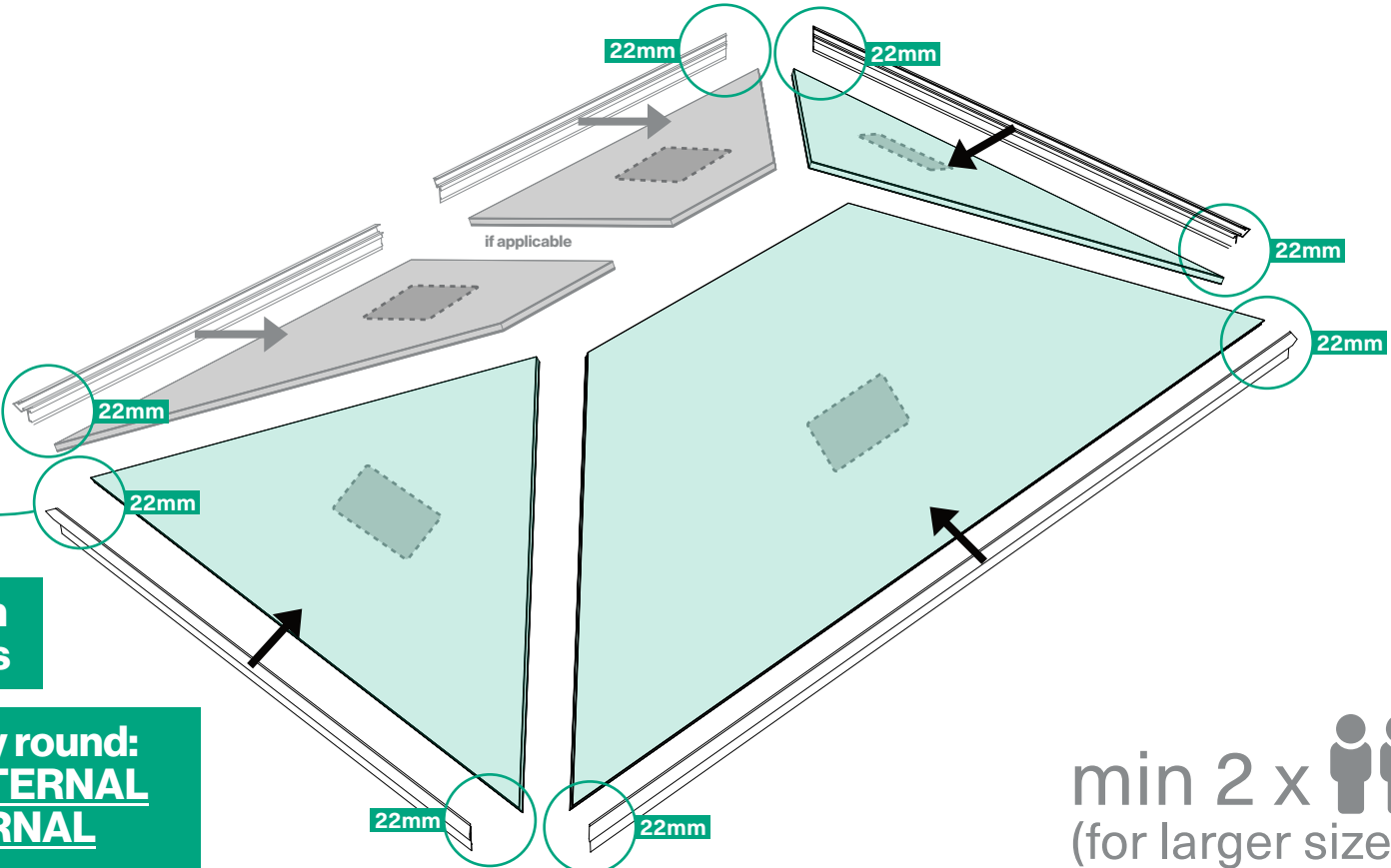

22mm

22mm

22mm

22mm

22mm

22mm

22mm

22mm

if applicable



Use suitable cut protection gloves while handling glass



Ensure glass is correct way round:
Laminate labelled face to **INTERNAL**
and self-clean side to **EXTERNAL**

min 2 x 
(for larger sizes)

7. Fit glass to frame and align corners

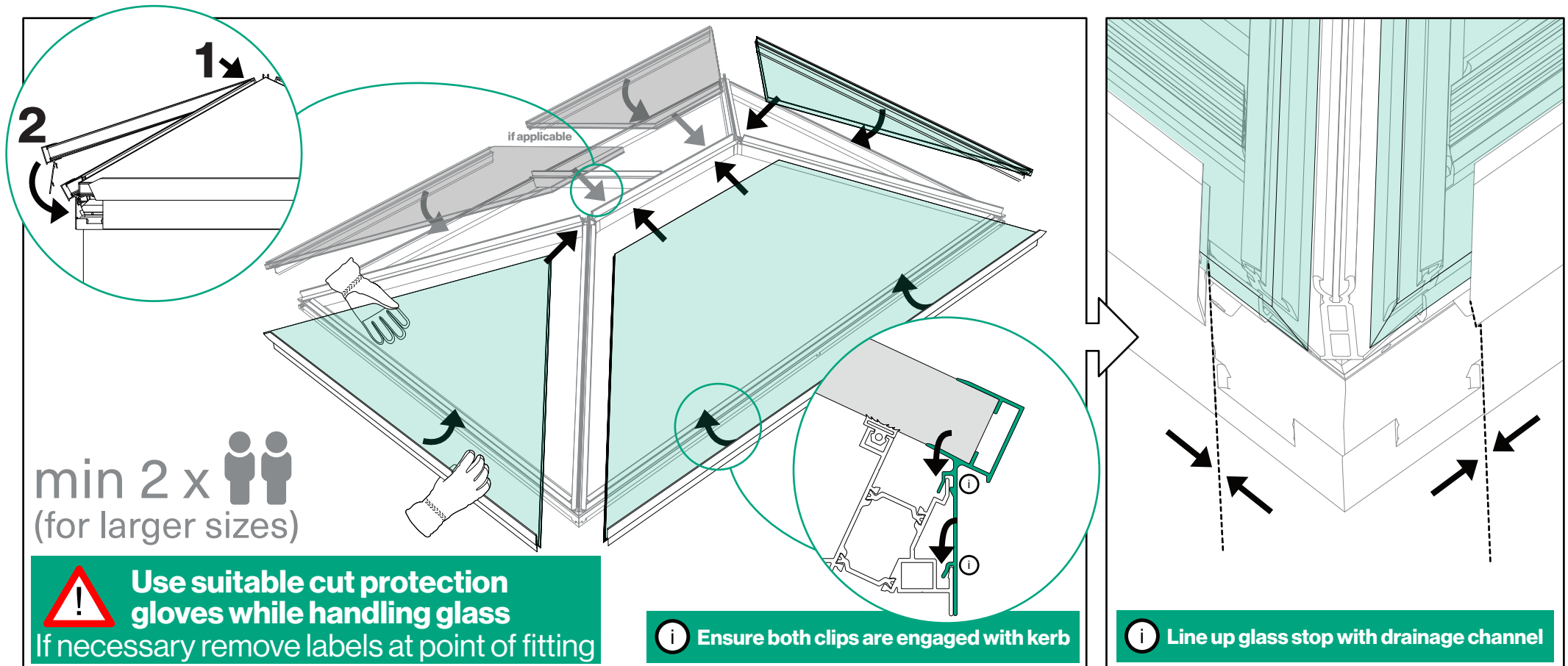

8. Position glazing clamps

4 & 6 pane lantern only

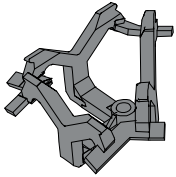

2 x
Glazing Clamp

Pyramid only

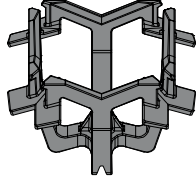

1 x
Glazing Clamp

4 & 6 pane lantern only

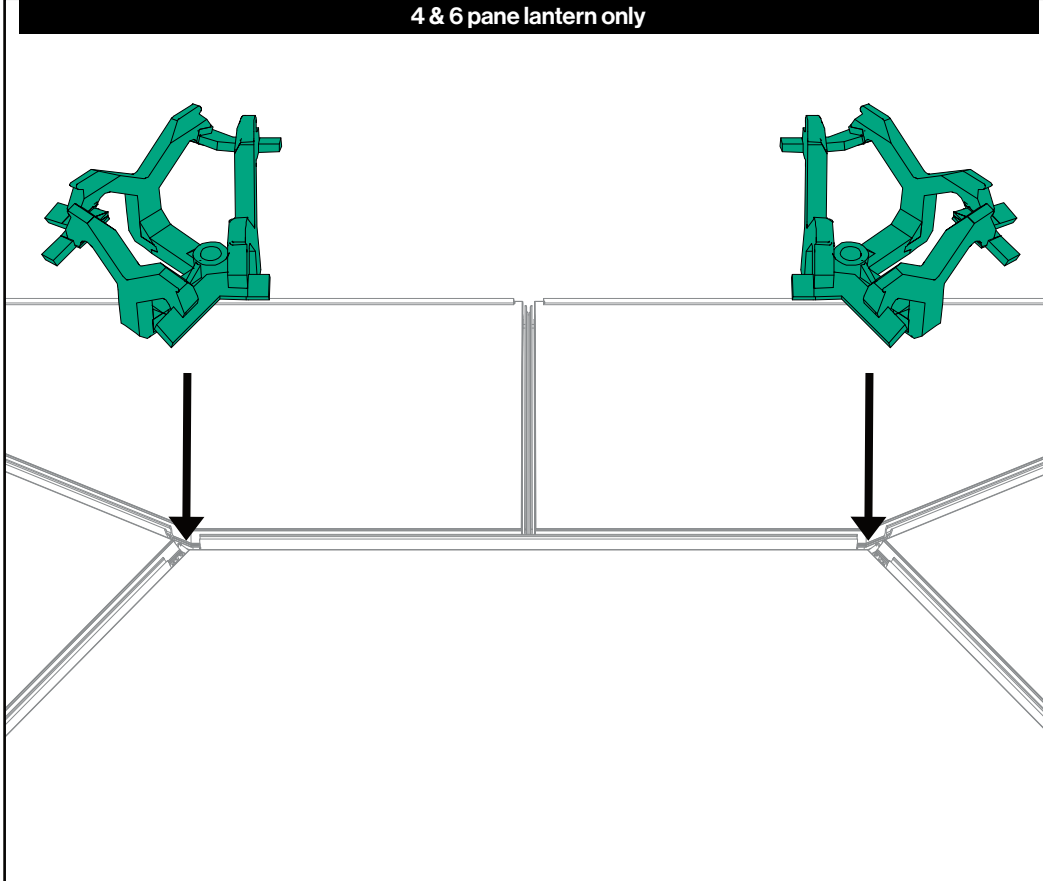

Pyramid only

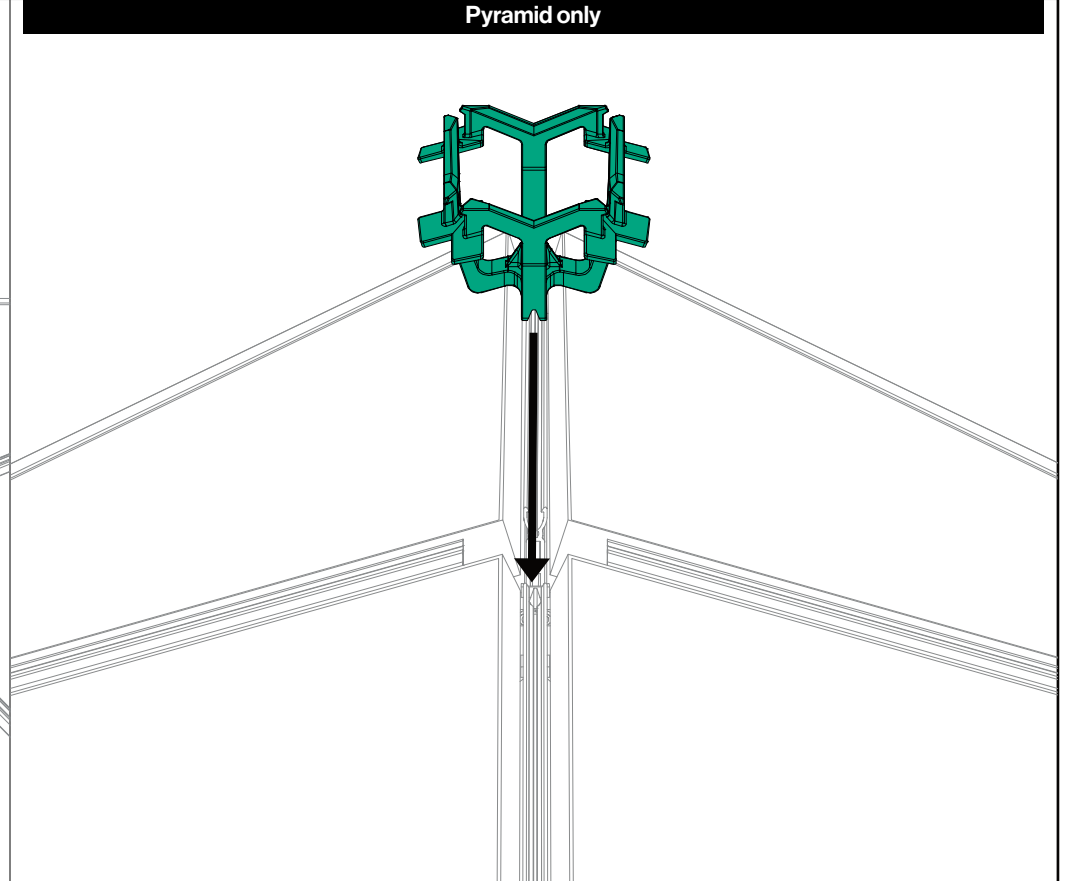

9. Align and clip on hip outers (and rafter outers for 6 pane lantern)

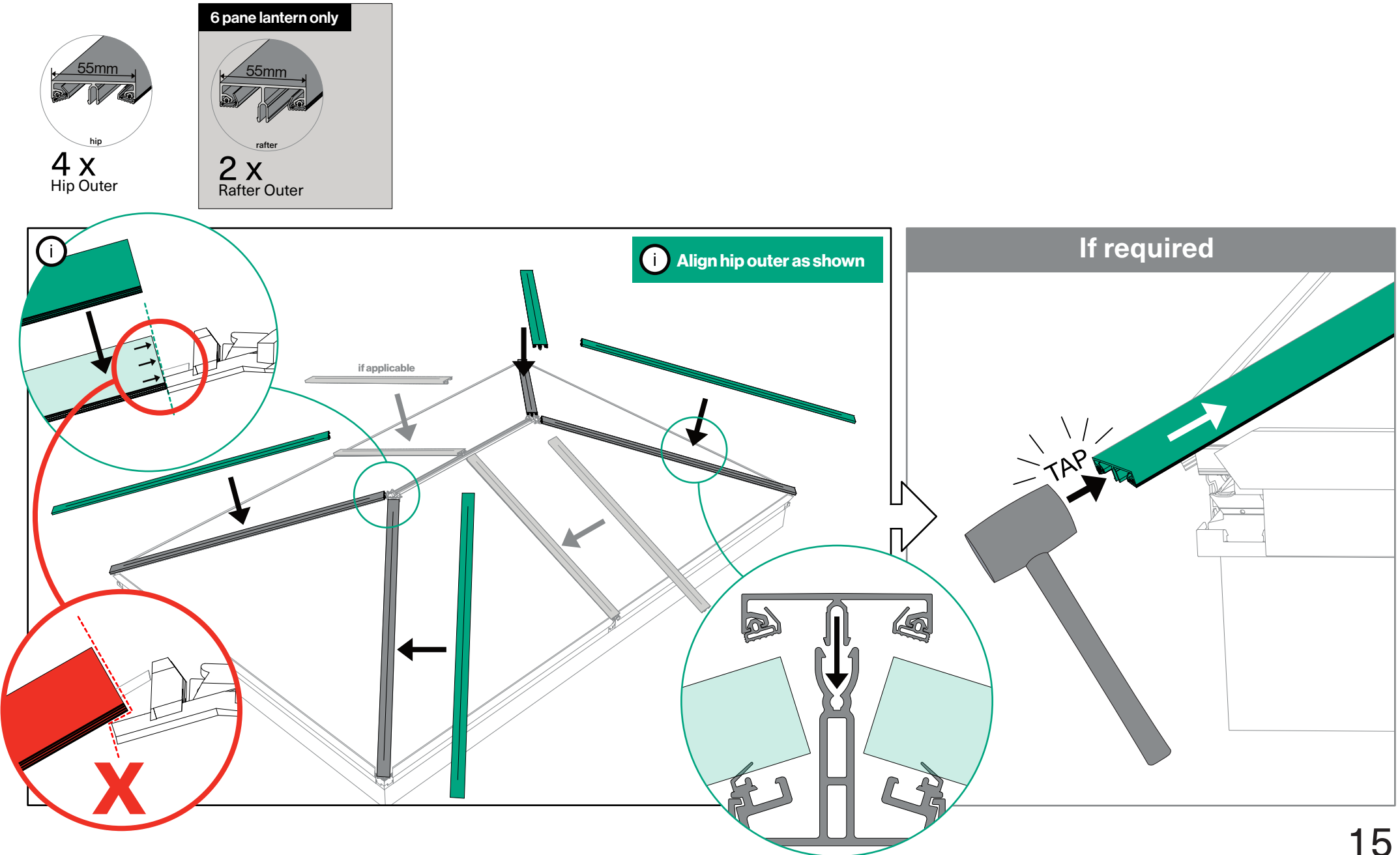

10. Align and clip on ridge outer and fix down glazing clamps

4 & 6 pane lantern only



2 x
M6x25mm
Glazing Clamp Bolts

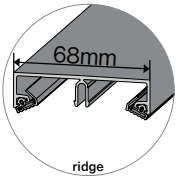

1 x
Ridge Outer

Pyramid only



1 x
M6x25mm
Glazing Clamp Bolt

4 & 6 pane lantern only

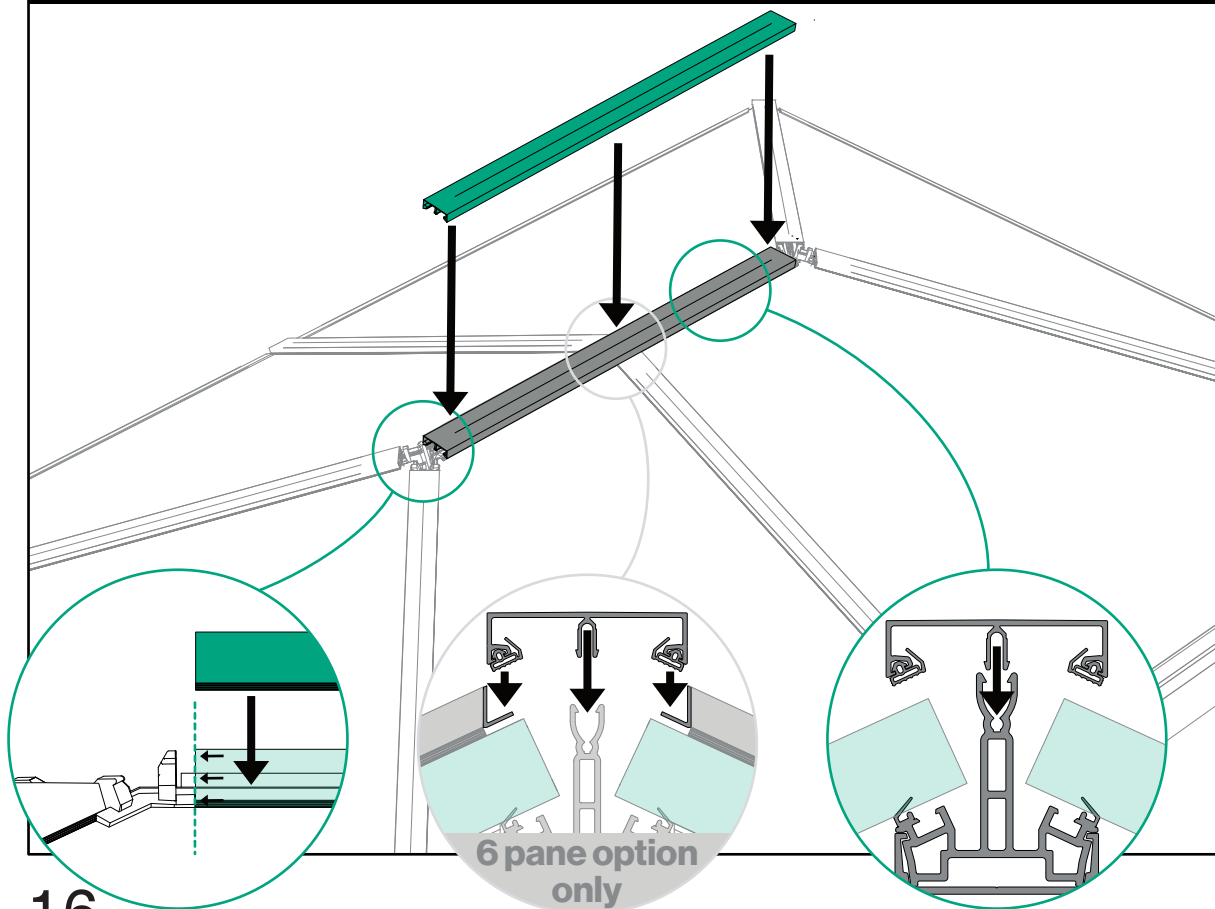

6 pane option only

Pyramid only

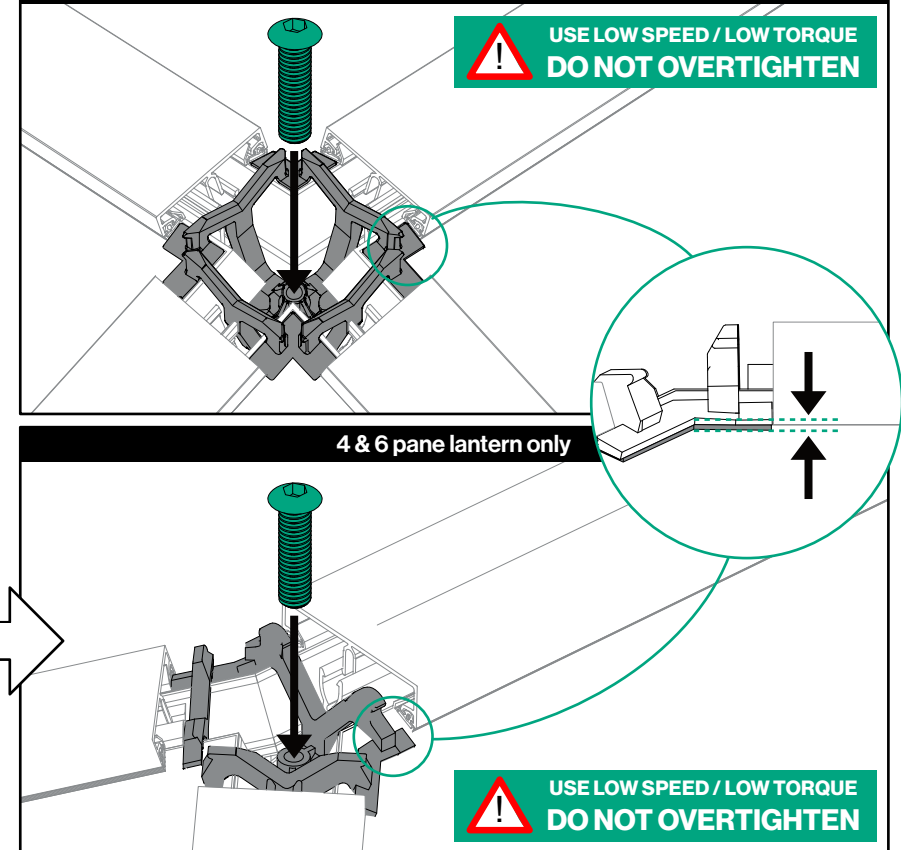

USE LOW SPEED / LOW TORQUE
DO NOT OVERTIGHTEN

4 & 6 pane lantern only

USE LOW SPEED / LOW TORQUE
DO NOT OVERTIGHTEN

11. Clip on ridge caps

4 & 6 pane lantern only

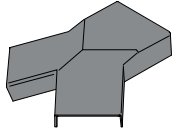

2 x
Ridge Cap

Pyramid only

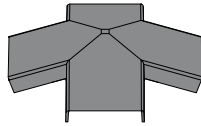

1 x
Ridge Cap

4 & 6 pane lantern only

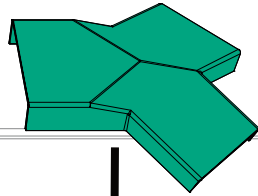
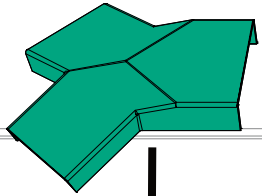

Pyramid only

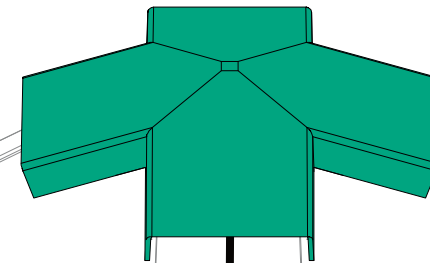

12. Attach hip caps

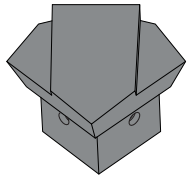

4 X
Hip Cap

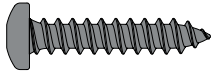

8 X
No. 10x25mm
Outer Cap Screws

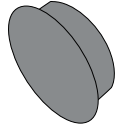

8 X
Cover Cap

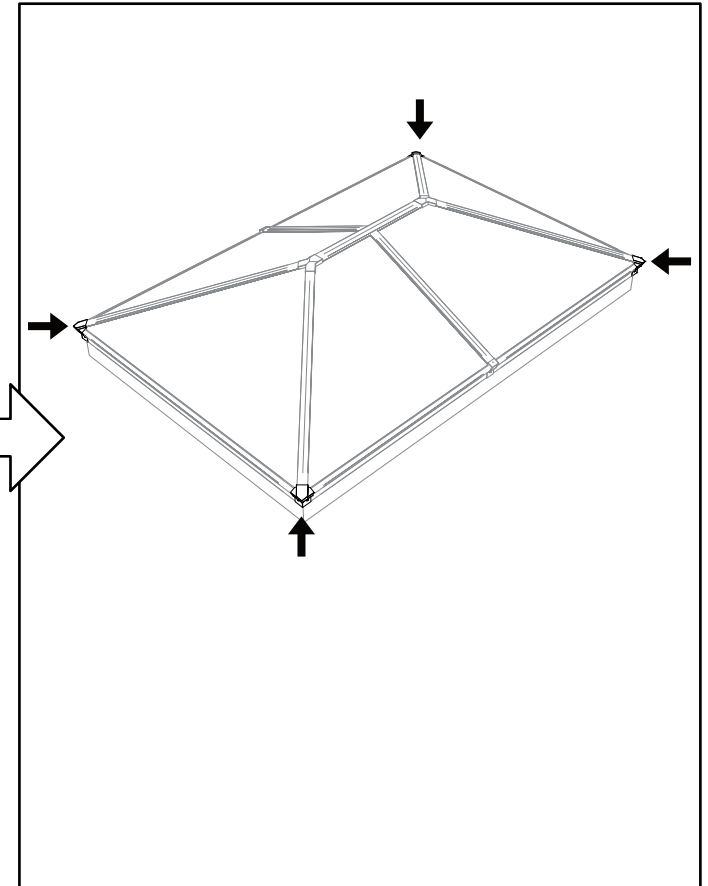
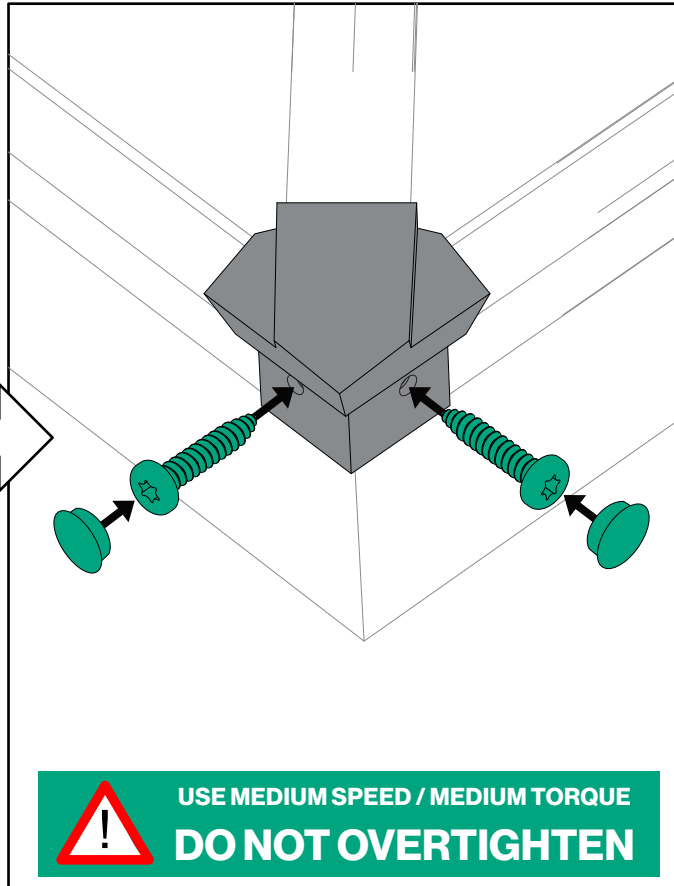
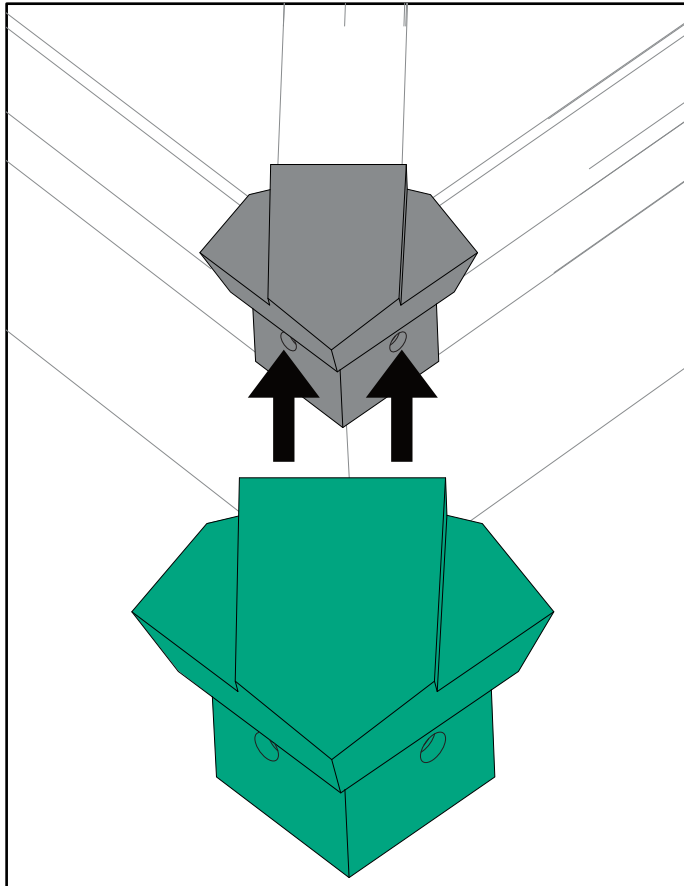

13. Attach rafter caps (6 pane lantern only)

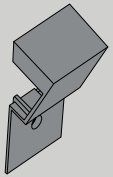

2 x
Rafter Cap

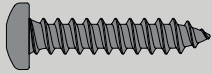

2 x
No. 10x25mm
Outer Cap Screws

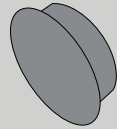

2 x
Cover Cap

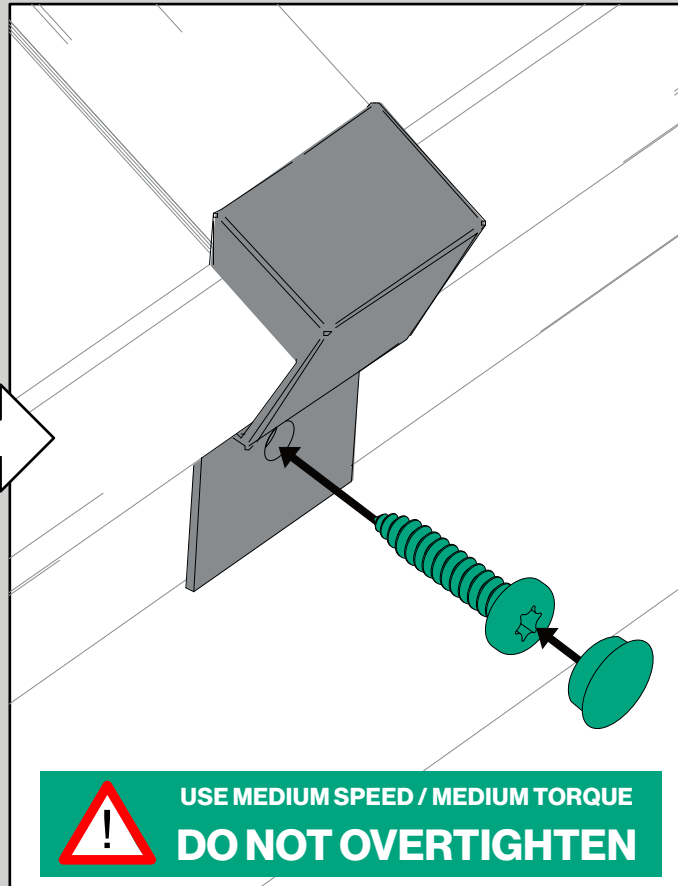
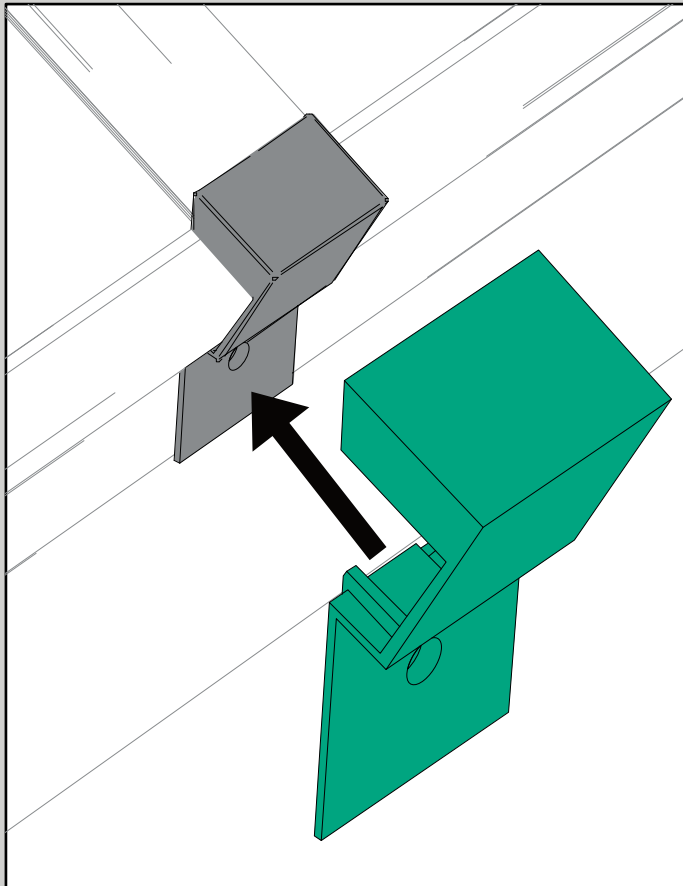

USE MEDIUM SPEED / MEDIUM TORQUE
DO NOT OVERTIGHTEN

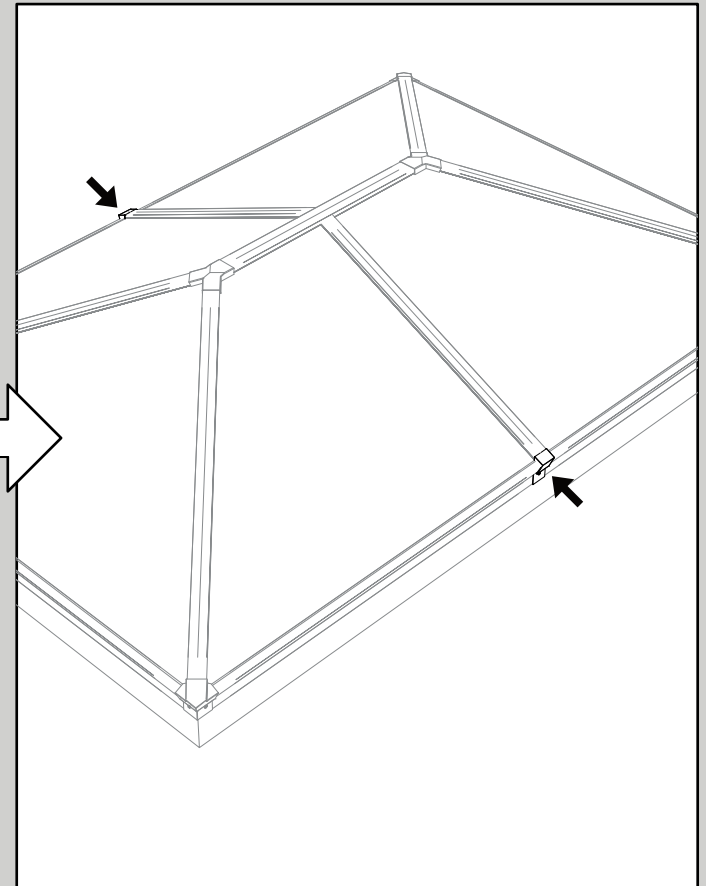



Brett Martin Daylight Systems

Sandford Close
Aldermans Green Industrial Estate
Coventry, West Midlands
CV2 2QU
t: +44 (0) 24 7660 2022
f: +44 (0) 24 7660 2745
e: daylight@brettmartin.com

For the latest information visit
brettmartin.com